



The DoubleTree by Hilton Hotel and Suites Houston by the Galleria is a place where you can stay together with your group and business colleagues. Our new combination of large room types, communal lounges, global menus, proximity to the Galleria® and everyday amenities allows you to stay close to what makes you feel at home. There's room for everyone at DoubleTree, where you "Create Your Kind of Comfort".

ACCOMMODATIONS

DoubleTree by Hilton Hotel & Suites Houston by the Galleria has Texas-sized suites that meet every need, including business travelers, families and groups.

- 238 Guest Rooms, approximately 430 sq ft
- 238 Suites, approximately 870sq ft
- All suites offer full kitchens with residentialsize appliances
- Sweet Dreams® by DoubleTree sleep experience
- Wireless high-speed internet access and remote guest-room printing
- On-demand movies and premium television channels (HBO®, CNN®, ESPN®)
- In-room safes
- Ironing board, iron and hair dryer
- Sweet Dreams alarm clock radio with MP3 connectivity
- USA Today® available at the concierge desk
- Two telephones, voicemail and data port
- Most suites include balconies and beautiful city views
- Gourmet Coffee and Tea

AT YOUR SERVICE

- Same-day laundry
- Self and valet parking; daily fee
- Concierge available weekdays in our HHonors Lounge
- 24-hour Tech Center
- 24 Hour Fitness by Precor
- ATM located in Lobby
- Car Rental desk – Lobby Level

SURROUNDING ATTRACTIONS

- Galleria Mall – Across the street
- Memorial Park – 2 Miles
- Rice University / Rice Village – 3 Miles
- Houston Museum District – 4 Miles
- Theater District – 7 Miles
- Minute Maid Park – 7 Miles
- George R. Brown Conv. Center – 7 Miles
- Toyota Center – 7 Miles
- NASA / Space Center Houston – 25 Miles
- Galveston Island – 55 Miles

LOCATION

Our hotel is in the heart of the thriving retail and business hub known as the Galleria / Uptown District. Reknown for world-class shopping at the Galleria Mall, the best dining options in the city and in the midst of numerous fortune 500 Companies – the Galleria is the place to stay, work and play. We offer complimentary hotel shuttle service within a 3- mile radius.

DINING + ENTERTAINMENT

No matter what you're hungry for, you'll find our kitchen is always open. Breakfast, lunch, dinner or in-between, DoubleTree has something to offer. Whether you are ordering suite service, enjoying McKinley's Restaurant or relaxing in the Lobby or Mezzanine with a cocktail, you'll find we always have something cooking that's fresh and tasty.

- McKinley's – located on our second level
- In-Suite Dining Service – 6:00am to 10:30pm
- Lobby Lounge
- Grab N Go Market

HILTON HHONORS™

With Hilton HHonors™, you can earn points towards free nights every time you stay at one of our ten distinct brands and can even earn rewards for booking a meeting or event. With a hotel for every style, budget and occasion, Hilton HHonors lets you transform points into memories you can't help but share at more than 3,900 hotels and resorts worldwide.

Not a member? Join now by visiting HHonors.com/join Hilton HHonors™ membership, earning of Points & Miles™ and redemption of points is subject to HHonors Terms and Conditions.

©2016 Hilton Worldwide



CREATE YOUR KIND OF COMFORT

5353 WESTHEIMER ROAD, HOUSTON, TEXAS, 77056-5474, USA

TEL: +1-713-961-9000 FAX: +1-713-877-8835 HOUSTONSUITES.DOUBLETREE.COM



DOUBLETREE

BY HILTON™

HOTEL & SUITES
HOUSTON BY THE GALLERIA



SECOND LEVEL

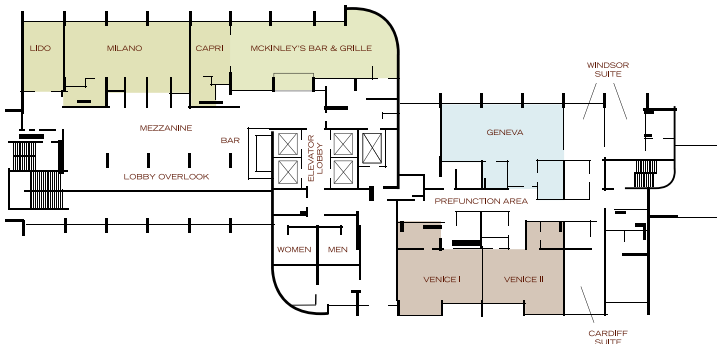

LOBBY LEVEL

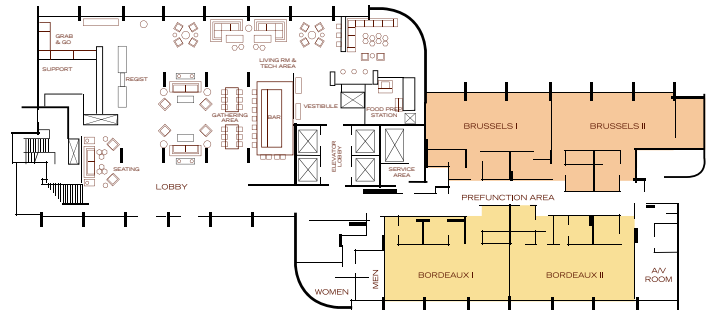

Name of Room	Total Sq. Ft.	Dimensions	Banquet	Reception	Classroom	Theatre	Conference	U-Shape	H-Square
Brussels I	780	20' x 39'	50	50	30	70	30	25	25
Brussels II	780	20' x 39'	50	50	30	70	30	25	25
Brussels I & II	1,560	20' x 39'	120	100	85	175	60	50	50
Bordeaux I	780	20' x 39'	50	50	30	70	3	25	25
Bordeaux II	780	20' x 39'	50	50	30	70	30	25	25
Bordeaux I & II	1,560	20' x 78'	120	100	85	175	60	50	50
Geneva	780	20' x 39'	60	50	30	60	30	25	25
Venice I	540	20' x 27'	40	40	25	30	20	20	20
Venice II	540	20' x 27'	40	40	25	30	20	20	20
Venice I & II	1,080	20' x 54'	80	80	60	100	40	40	40
Lido/Milano/ Capri/McKinley's	2,220	20' x 111'	200	250	-	-	-	-	-
Lido	260	20' x 13'	20	10	-	-	-	-	-
Milano	800	20' x 40'	60	100	60	75	50	40	40
Capri	260	20' x 13'	20	10	-	-	-	-	-
Lido/Milano/Capri	1,320	20' x 66'	120	150	85	150	60	50	50
McKinley's Bar and Grille	900	20' x 45'	80	100	-	-	-	-	-
Mezzanine	1,482	26' x 57'	80	125	-	-	-	-	-

CREATE YOUR KIND OF COMFORT

5353 WESTHEIMER ROAD, HOUSTON, TEXAS, 77056-5474, USA

TEL: +1-713-961-9000 FAX: +1-713-877-8835 HOUSTONSUITES.DOUBLETREE.COM